

**SYSTEMS**  
**FAB & MACHINE**

**SYSTEMS**

**50**  
**YEARS**





# FABRICATING THE WORLD OF TOMORROW ... TODAY.

All the structural steel seen in this photo was prefabricated by Systems Fab & Machine. Systems Contracting erected the steel, set the equipment, and installed the piping.

This project began with our engineering design and detailing staff creating the 3D wireframe model shown inside.



Utilizing our SDS/2 Steel detailing software, we are able to generate wire frame drawings of complex structures and then let SDS/2 automatically generate connections.

Once drawings are checked, we can download CNC files for all members and connection material to then be processed on our CNC beam lines, CNC angle line, CNC plate duplicator or CNC plate burning table.

Spray-Cooled™ Equipment  
New Fabrication and Rebuilds



Machining and Fabrication Services

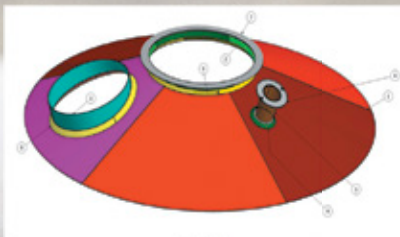

Spray-Cooled™ Spare Parts - Menu Pricing

QTY	UNIT	DESCRIPTION	UNIT PRICE	TOTAL PRICE
1	EA	1/2" DIA. STEEL FLANGE - 304 SS	150.00	150.00
1	EA	1/2" DIA. STEEL FLANGE - 304 SS	150.00	150.00
1	EA	1/2" DIA. STEEL FLANGE - 304 SS	150.00	150.00
1	EA	1/2" DIA. STEEL FLANGE - 304 SS	150.00	150.00
1	EA	1/2" DIA. STEEL FLANGE - 304 SS	150.00	150.00
1	EA	1/2" DIA. STEEL FLANGE - 304 SS	150.00	150.00
1	EA	1/2" DIA. STEEL FLANGE - 304 SS	150.00	150.00
1	EA	1/2" DIA. STEEL FLANGE - 304 SS	150.00	150.00
1	EA	1/2" DIA. STEEL FLANGE - 304 SS	150.00	150.00
1	EA	1/2" DIA. STEEL FLANGE - 304 SS	150.00	150.00

Systems Fab & Machine produces straight handrails, stair handrails and circular handrails from all material shapes and material types, and can provide any coating to meet customer specifications.



# WE INSPIRE A LEVEL OF CONFIDENCE UNMATCHED BY OUR COMPETITORS.



SCAN TO LEARN MORE  
ABOUT SYSTEMS FAB  
& MACHINE

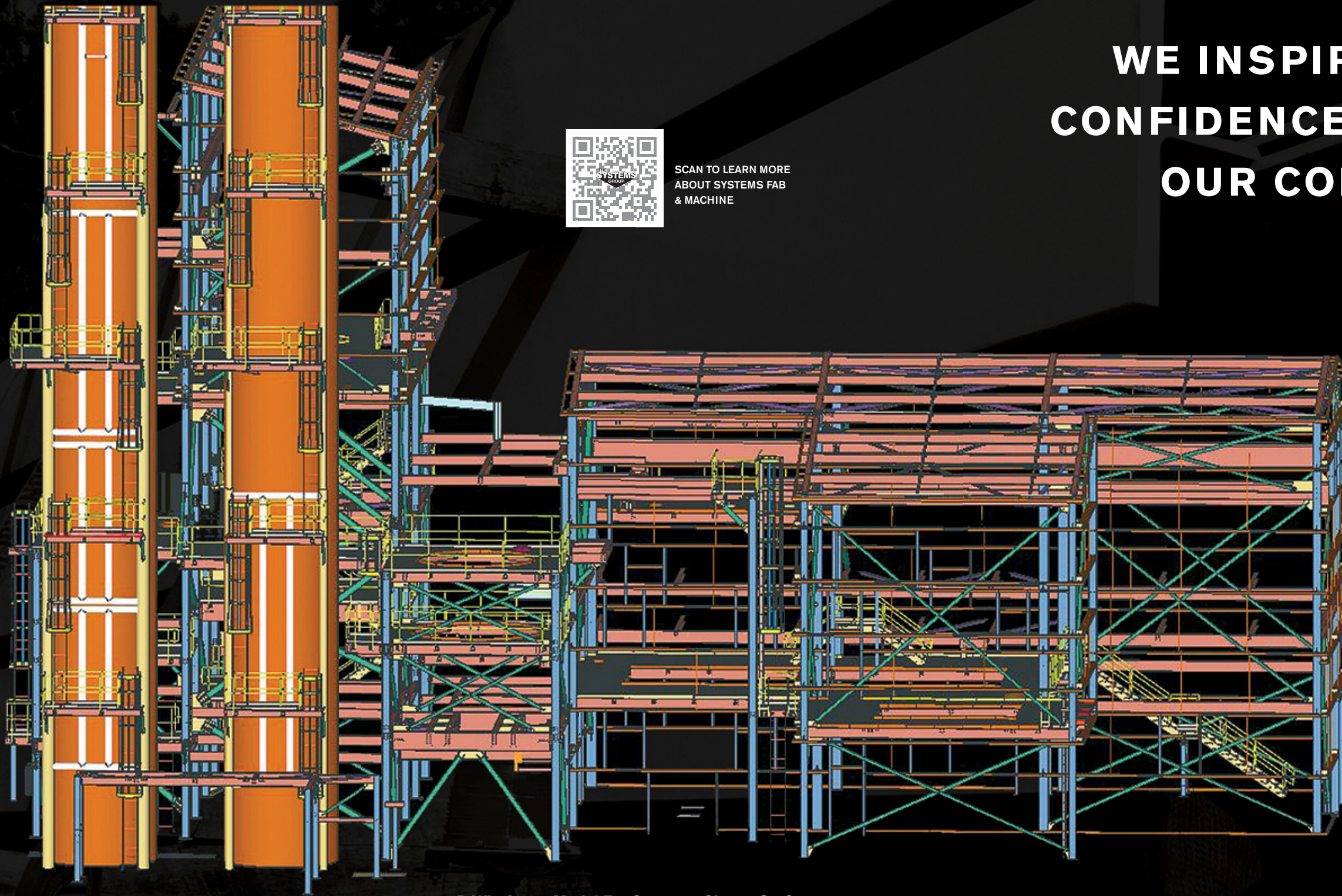

3D Wireframe Model For Structure Shown On Cover

AISC ~ American  
Institute of Steel  
Construction  
Certified Fabricator  
for standard  
building structures

Systems Fab  
and Machine  
can fabricate  
all types of  
industrial  
structural steel.

**QUALITY  
CONTROL**

**DIVERSITY**

**STATE-OF-  
THE-ART  
SOFTWARE**

AISC  
Sophisticated  
Painting  
Endorsements  
P2 & P3

We are  
experienced  
in developing  
complex models  
using Auto-Cad  
software.

We utilize  
the latest SDS/2  
steel detailing  
software.





In addition to industrial work, Systems Fab & Machine is an AISC Certified Fabricator with the experience and capabilities to handle all types of fabrication projects. In the commercial market we have fabricated structural steel for:

- Major League Baseball Parks
- Hospitals
- Schools
- Office Buildings



We can fabricate anything from a ship ladder stair to a multi-level industrial stair tower. If your project requires it, we can shop bolt stair assemblies after coating to reduce erection cost.

Systems also has proven experience in ASME code welding.



Investing in state-of-the-art technology, our Rotoweld machine is capable of welding an 8" SCH 40 pipe in less than 8 minutes, that's with root and cap. Save time and money using our Shop fabrication capabilities compared to welding in the field.

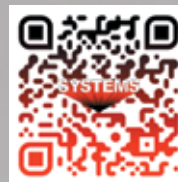
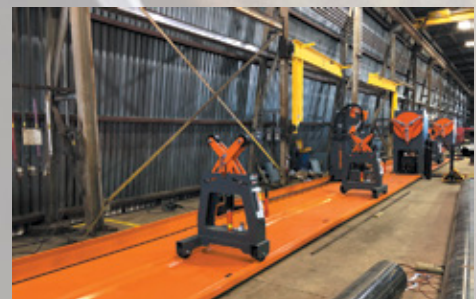

SCAN TO LEARN  
MORE ABOUT  
SYSTEMS ROTO  
WELDER

With the continual investments in our facilities, technology and our Team Members we have grown greatly over the years, and have shipped fabrication to almost every state in the U.S. as well as internationally to Canada, Mexico, Costa Rica, South Africa, Trinidad and Thailand.



BLYTHEVILLE,  
ARKANSAS

SYSTEMS  
CONTRACTING CORPORATION  
TION & MACHINE

SYSTEMS

EL DORADO, ARKANSAS

**SYSTEMS**  
FAB & MACHINE

COLUMBUS, MISSISSIPPI

With over 50 years of fabrication and machining experience, Systems Fab & Machine has the capabilities to fit your needs. From design to fabrication to painting and galvanizing to shipping, we have you covered. Our primary capabilities include:

- Spray-Cooled™ Equipment
- Structural Steel
- Pipe Fabrication
- ASME Vessels
- API Tanks
- OEM Equipment
- Large Duct and Stack Fabrication
- Handrails
- Ladders
- Stair Towers
- Platforms
- Complex Fabrications
- Heavy Machining

[fabmachine.tsg.bz](http://fabmachine.tsg.bz) • (870) 862-1393